



3512 Tallangatta Creek Road Tallangatta Valley VIC

2 2 1

Nestled within the tranquil embrace of natural bushland, this expansive 31.92-hectare estate, approximately 80 acres, boasts a rich history dating back over 80 years. Formerly the esteemed old Scout and Cravensville School campsite, this property exudes character and offers a unique blend of rustic charm and modern comforts. Situated across 2 titles, this residence is a haven for those seeking a peaceful rural lifestyle with abundant opportunities for agriculture and leisure.

Residence: The heart of this property is a charming residence steeped in history. The main building features a cosy ambiance with two bedrooms, including a master bedroom adorned with an air-conditioning unit and a spacious walk-in robe. The kitchen is equipped with modern conveniences such as a gas oven and an Omega dishwasher, complemented by the rustic appeal of an old

Price : \$649,000
Land Size : 31.9247 ha
View : <https://www.wodongarealestate.com.au/sale/vic/north-eastern/tallangatta-valley/residential/rural/7961143>



Silviya Saric
0260 561 888

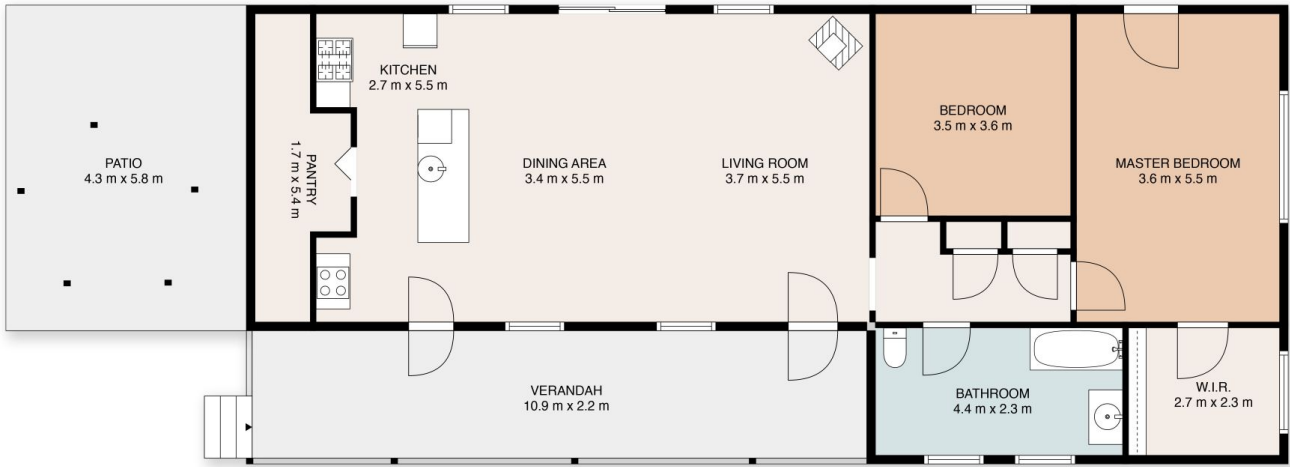

Residence

This floor plan including dimensions are approximate and are for illustrative purposes only and should be used purely as a guide. No guarantee can be given to accuracy of the information contained, and interested parties should conduct their own enquires.

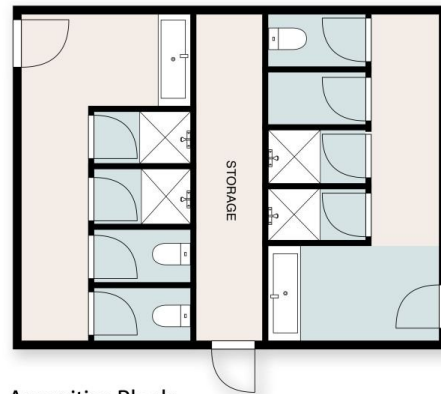

Amenities Block

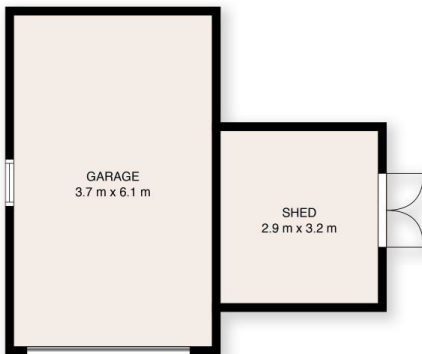

This floor plan including dimensions are approximate and are for illustrative purposes only and should be used purely as a guide. No guarantee can be given to accuracy of the information contained, and interested parties should conduct their own enquires.