



25 High Street Wodonga VIC

Presented for sale for the first time since its origin in 1963 this sought after piece of commercial property offers a broad range of buyers many possibilities.

Ideal central location with main street frontage/high traffic exposure plus easy access to the Hume freeway, some of the many features include:

- ? 180m² approx. building comprising office, showroom, workshop and washroom/toilet
- ? Two vehicle access points with front/side access to the secure 1012m² allotment and rear access to the workshop
- ? 3 phase power

Lease: Three years commencing on 15/06/2022
 Option: Two (2) further one (1) year options
 Rent: \$26,000.00 per annum plus outgoings of council and

Price : \$ 650,000
Building Size : 180 sqm
Land Size : 1012 sqm
View : <https://www.wodongarealestate.com.au/sale/vic/north-eastern/wodonga/commercial/industrial/7610411>



Clinton Harvey
0260 561 888



Clint Ilesley
0260 561 888

25 High Street,
Wodonga

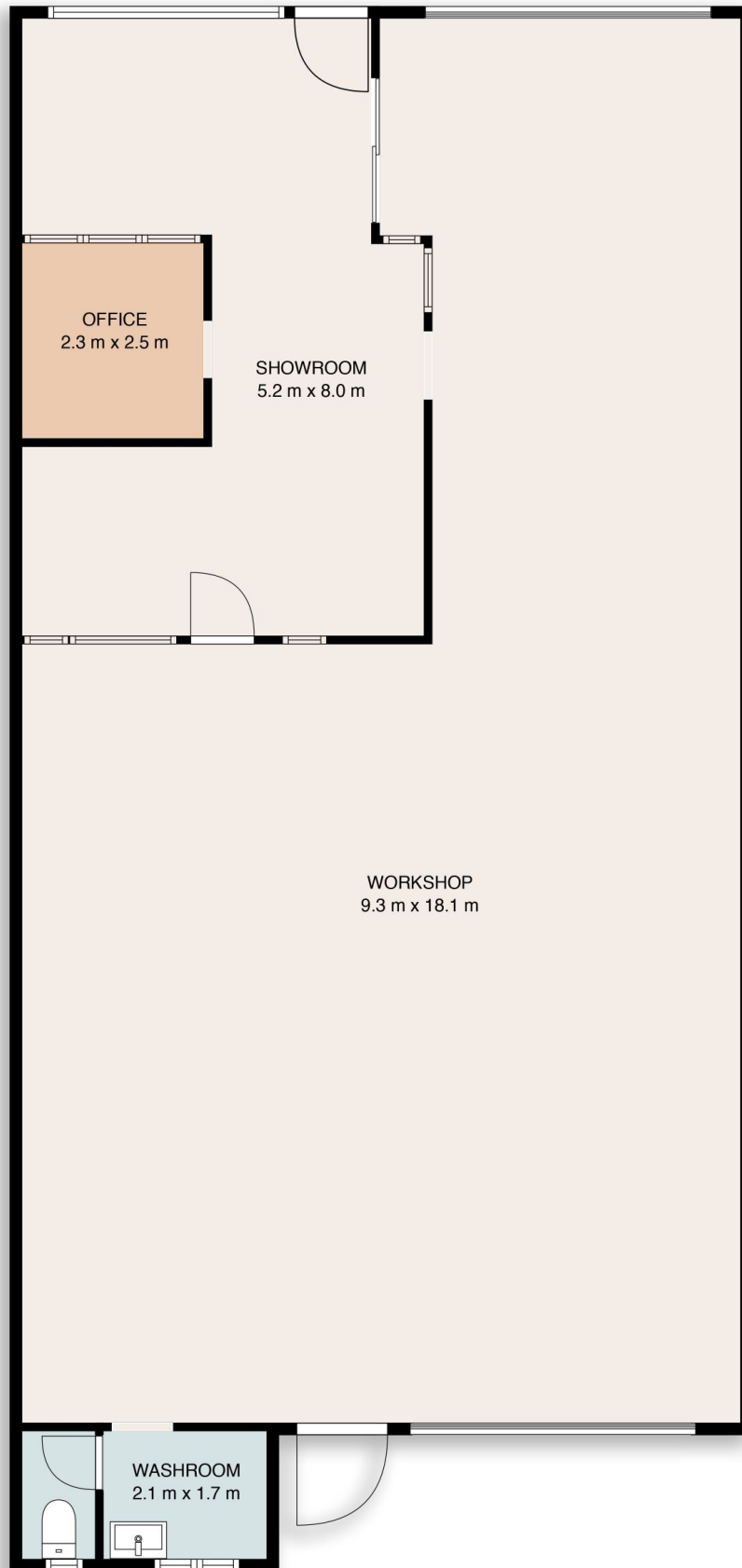

This floor plan including dimensions are approximate and are for illustrative purposes only and should be used purely as a guide. No guarantee can be given to accuracy of the information contained, and interested parties should conduct their own enquires.