



## 6 Bridge Street Bethanga VIC

1 1

NOTE: Site assessment for Effluent Disposal System Report for the installation of an effluent disposal system on the land has been completed by Aitken Rowe Testing Laboratories (Consultants in Environmental & Geotechnical Engineering and Testing) and is available upon request.

**Price** : \$ 286,000  
**Land Size** : 2703 sqm  
**View** : <https://www.wodongarealestate.com.au/sale/vic/north-eastern/bethanga/residential/house/7084945>

Have you ever dreamed of owning your own church?

The Church known to locals as St. Francis Catholic Church has retained all its endearing features such as lofty cathedral ceilings, lancet windows and original weatherboard exterior.

With solid double wooden doors leading to the entrance of the church the interior initially flows into the vestibule, then onto the main nave with 4.7 metre ceiling heights, electric mounted radiators and 2 ceiling fans.

A raised altar at the far end of the church leads through to



**Silviya Saric**  
0260 561 888

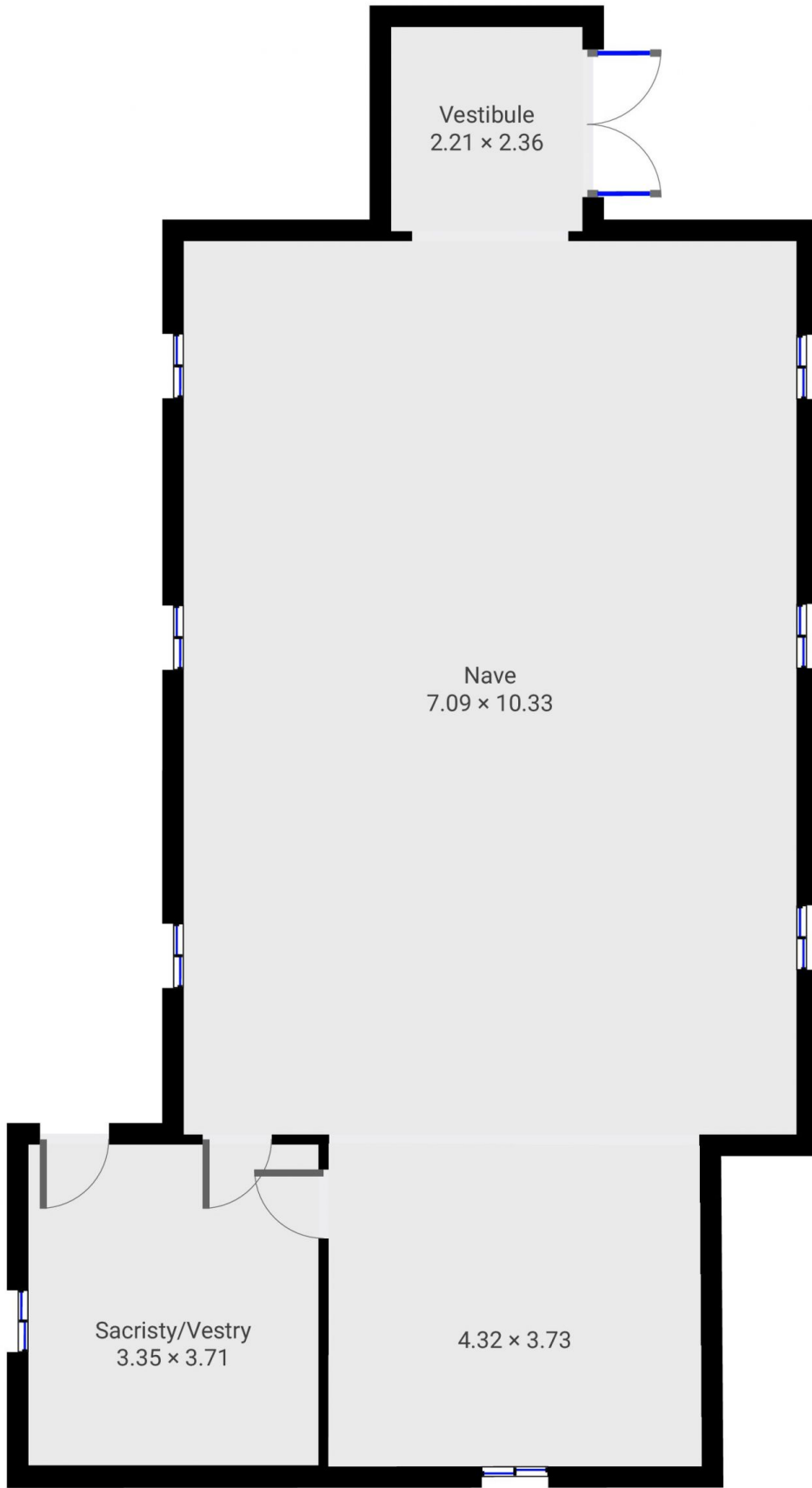

THIS FLOORPLAN IS PROVIDED WITHOUT WARRANTY OF ANY KIND. SENSOPIA DISCLAIMS ANY WARRANTY INCLUDING, WITHOUT LIMITATION, SATISFACTORY QUALITY OR ACCURACY OF DIMENSIONS.