



**14 Yamba Street Tallangatta VIC**

2 1 2

Fresh to the market this great Brick Veneer home on an easy to manage flat block of approx. 600m<sup>2</sup> with scenic views to Lake Hume.

Great living areas with sunken lounge, dining area and newly renovated kitchen with stainless steel appliances.

Double door Fridge plumbed in with ice-making facility and a 65 inch Samsung LCD wall mounted TV are included in the package.

Carpets and robes in both bedrooms, with split system cooling and ducted heating for year round comfort.

Garage can be used as a workshop or have carport and use garage for extra storage, with a separate garden shed in the back yard.

Noted Secondary College is an easy walk so maybe attractive as an investment. Two primary schools are also within an easy stroll of the home.

Tallangatta is a progressive township only 30 minutes from

**Price** : \$ 215,000  
**Land Size** : 600 sqm  
**View** : <https://www.wodongarealestate.com.au/sale/vic/north-eastern/tallangatta/residential/house/5837506>



**Silviya Saric**  
**0260 561 888**

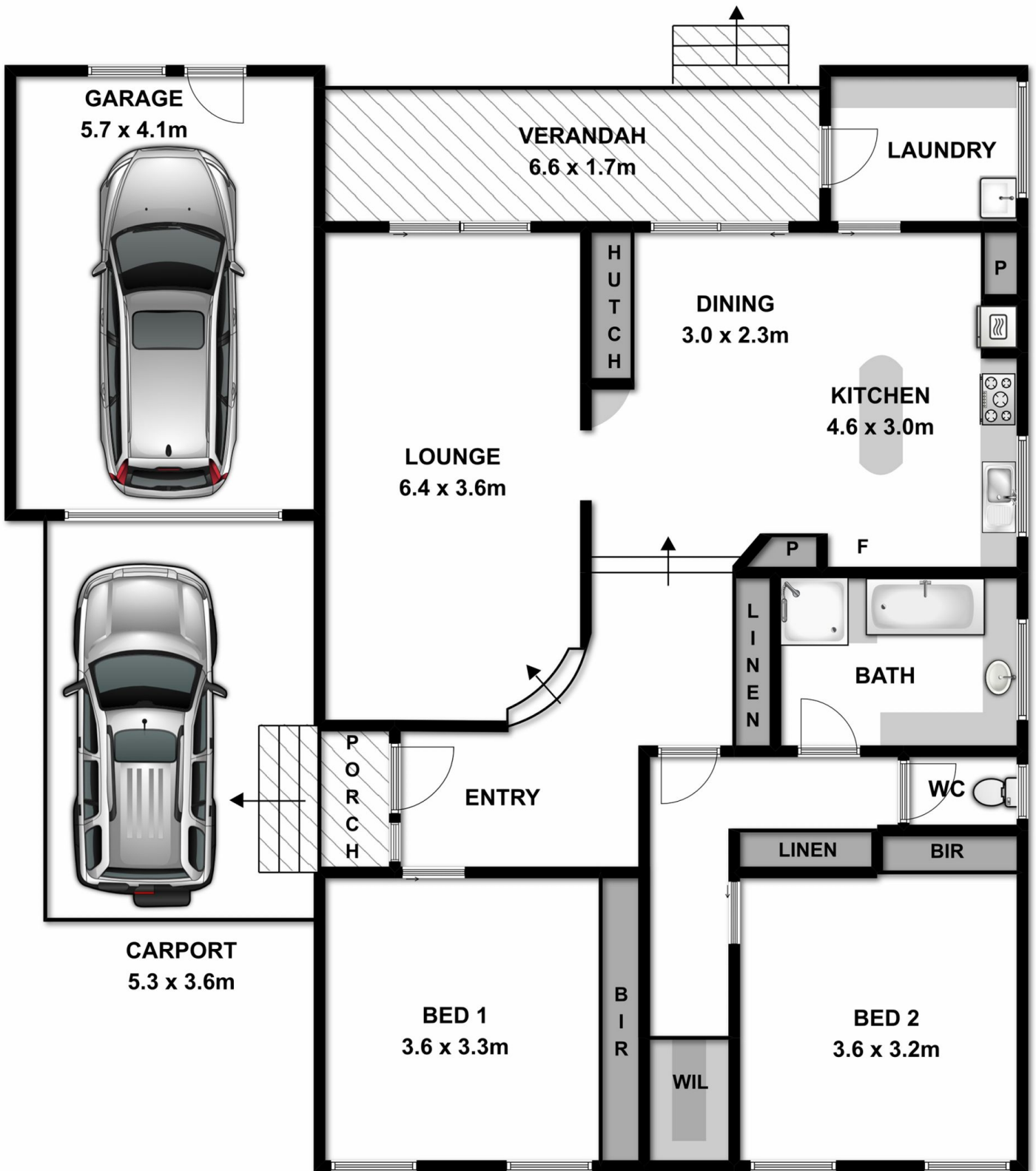

Measurements are approximate. Not to scale. For illustrative purposes only.