



**wodonga real estate
bestagents**



20 Davenport Street Killara VIC

5 3 3

This beautiful quality built home has taken INDULGENCE to a new level.

This spacious modern designed home has it all. Luxurious master suite includes a spacious dressing room, with built in drawers and shelving.

Ensuite with great bench space, large shower.

Large guest bedroom boasts enough room for a retreat, with ensuite, and built-in robe with drawers and shelving.

Remaining three bedrooms all have built in robes with drawers and shelving, all with sliding doors.

Spacious main bathroom.

Open plan kitchen, living, and dining with stone benchtops, stainless steel 900mm cooktop and oven, glass splashback, and large walk in pantry.

Three separate living zones allowing the whole family to spread out and relax. Extra storage with a walk-in linen cupboard.

Land Size : 780 sqm

View : <https://www.wodongarealestate.com.au/sale/vic/north-eastern/killara/residential/house/5837408>



Margy Meehan
0260 561 888



Vanessa Meehan
0260 561 888

ALL GLASS TO CONFORM WITH AS1288-2006 : GLASS IN BUILDINGS

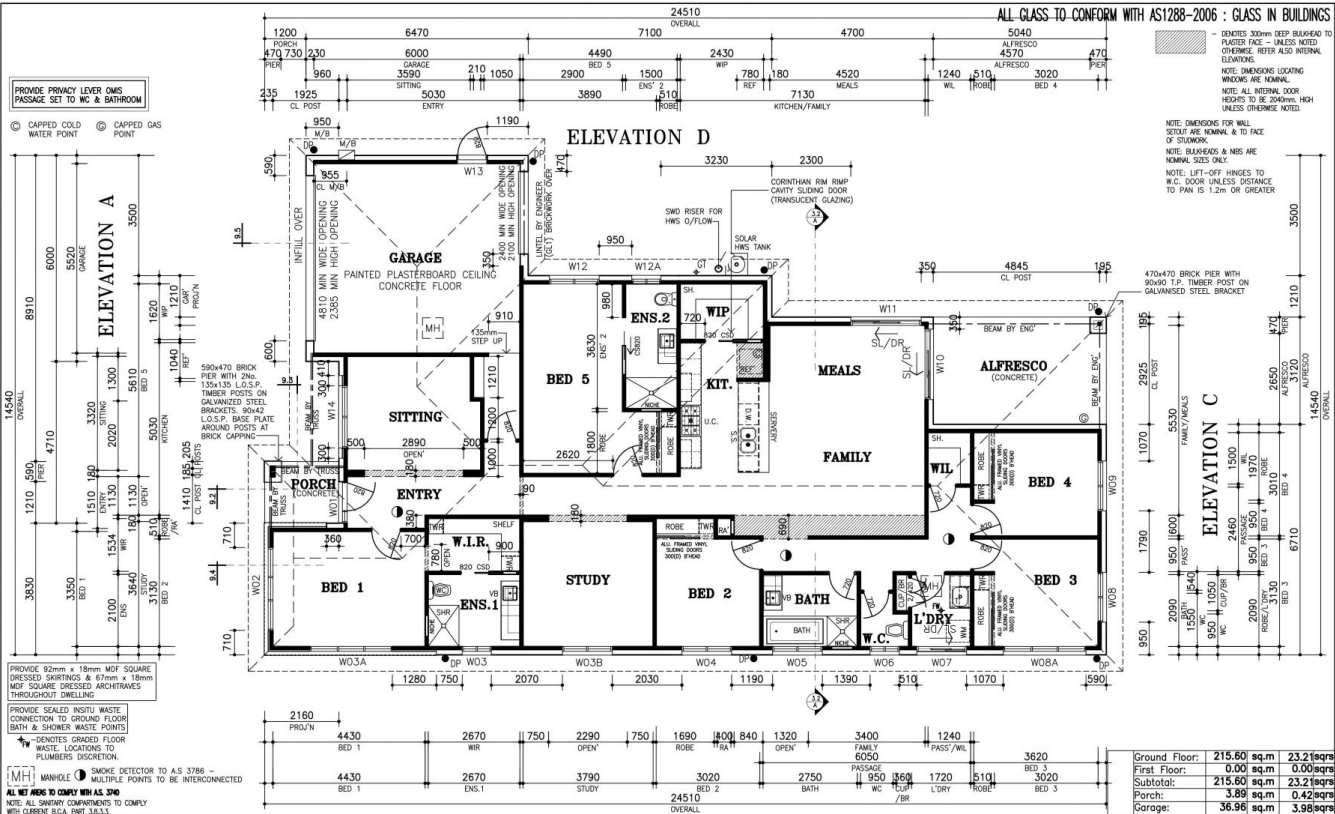

Ground Floor:	215.60 sq.m	23.21sq.m
First Floor:	0.00 sq.m	0.00sq.m
Subtotal:	215.60 sq.m	23.21sq.m
Porch:	3.89 sq.m	0.42sq.m
Garage:	36.96 sq.m	3.98sq.m
Alfresco:	15.72 sq.m	1.69sq.m
Total Area:	272.17 sq.m	29.30sq.m

ELEVATION B

<p>SIMONDS HOMES VICTORIA P/L ACN 050 197 610 ENQUIRIES 1300 SIMONDS</p> <p>HEAD OFFICE 1ST FLOOR 570 ST KILDA ROAD, MELBOURNE VIC 3004 INTERNET www.simonds.com.au</p> <p>TELEPHONE (03) 9682 0700 E-MAIL enquiries@simonds.com.au</p>		<p>Spec: NEW LIVING RANGE View: GROUND FLOOR PLAN</p>		<p>Scale: 1:100 @ 3</p> <p>Date: 27.10.16</p>
<p>FINAL CONSTRUCTION DRAWINGS</p> <p>CHECKED BY MICHAEL LONG ON 27-10-2016</p>		<p>Customer: H. A. BROWN & A. L. CHANDLER</p>		
<p>THE GREAT AUSTRALIAN BUILDER SIMONDS</p>		<p>Address: LOT 156 DAVENPORT STREET, KILLARA</p> <p>Sheet No: 2.1</p>		